



ADJUSTABLE MUSTACHE BAR for SOFTAIL/YAMAHA 7502

THANK YOU FOR CHOOSING KÜRYAKYN!

PROTECT YOURSELF AND OTHERS FROM POSSIBLE INJURY AND/OR PROPERTY DAMAGE OR LOSS. PAY CLOSE ATTENTION TO ALL INSTRUCTIONS, WARNINGS, CAUTIONS, AND NOTICES REGARDING THE INSTALLATION, USE, AND CARE OF THIS PRODUCT.



THIS INDICATION ALERTS YOU TO THE FACT THAT IGNORING THE CONTENTS DESCRIBED HEREIN CAN RESULT IN POTENTIAL DEATH OR SERIOUS INJURY.



This indication alerts you to the fact that ignoring the contents described herein can result in minor or moderate potential injury.

NOTICE

This indication alerts you to the fact that ignoring the contents described herein may negatively affect product performance and functionality or damage the product itself or the product to which it is being attached.

MAKE SURE THE FOLLOWING PARTS HAVE BEEN INCLUDED IN THE KIT:

- 2 1.25" Inner Clamp—Frame
- 2 1.25" Outer Clamp—Frame
- 2 1" Inner Clamp—Bar
- 2 1" Outer Clamp—Bar
- 1 Mustache Bar
- 1 Left Footpeg Clevis
- 1 Right Footpeg Clevis
- 2 Reducer Bushings
- 1 Hardware Kit containing:
 - 2 7/16"-14 X 1.5" hex head screw
 - 2 7/16"-14 X 1" hex head screw
 - 4 5/16"-18 X 3/4" socket head cap screw
 - 2 7/16"-14 acorn nut
 - 4 .875" X .47" ID X .063" washer
 - 2 3/8" thick wave washer
 - 2 3/8" thin wave washer
 - 2 3/8"-16 X 1" socket head cap screw
 - 2 5/16"-18 X 1" socket head cap screw
- 2 Double sided tape strips
- 1 Installation Instructions

NOTICE

This copy of installation instructions contains important information. Ensure that the end user receives this copy and is aware of its importance for future reference.

TOOLS SUGGESTED:

Set of combination wrenches, socket set and ratchet, set of hex wrenches



YOU WILL BE WORKING AROUND THE ENGINE AND EXHAUST SYSTEM DURING INSTALLATION. ENSURE THAT THE ENGINE AND EXHAUST SYSTEM HAVE FULLY COOLED TO PREVENT INJURY.

CUSTOMER SERVICE

877.370.3604 (toll free)

INSTALLATION QUESTIONS

techsupport@kuryakyn.com
or call 715.247.2983

LIMITED WARRANTY

Kuryakyn warrants that any Kuryakyn products sold hereunder, shall be free of defects in materials and workmanship for a period of one (1) year from the date of purchase by the consumer excepting the following provisions:

- Kuryakyn shall have no obligation in the event the customer is unable to provide a receipt showing the date the customer purchased the product(s).
 - The product must be properly installed, maintained and operated under normal conditions.
 - Kuryakyn makes no warranty, expressed or implied, with respect to any gold plated products.
 - Kuryakyn shall not be liable for any consequential and incidental damages, including labor and paint, resulting from failure of a Kuryakyn product, failure to deliver, delay in delivery, delivery in nonconforming condition, or for any breach of contract or duty between Kuryakyn and a customer.
- Kuryakyn products are often intended for use in specific applications. Kuryakyn makes no warranty if a Kuryakyn product is used in applications other than intended.
- Kuryakyn electrical products are warranted for one (1) year from the date of purchase by the consumer. L.E.D.'S contained in components of Kuryakyn products will be warranted for defects in materials and workmanship for 3 years from the date of purchase where as all other components shall be warranted for one(1) year. This includes, but is not limited to; control modules, wiring, chrome & other components.
- Kuryakyn makes no warranty of any kind in regard to other manufacturer's products distributed by Kuryakyn. Kuryakyn will pass on all warranties made by the manufacturer and where possible, will expedite the claim on behalf of the customer, but ultimately, responsibility for disposition of the warranty claim lies with the manufacturer.

ABOUT OUR CATALOG

For purchasing Kuryakyn® products, you can receive a complete catalog free of charge.

Send the Proof-of-Purchase below with your address to: Kuryakyn
454 County Road V V
Somerset, WI 54025-9031
Please indicate either Accessories Catalog for Harley-Davidson® or GL & Metric Cruisers.

Be sure to ask your local dealer about other Kuryakyn® products, the motorcycle parts and accessories designed for riders by riders.

©2005 Kuryakyn USA® All Rights reserved.



kuryakyn.com



Working around the sharp edges of the cylinder-head fins exposes your hands to injury. Wear protective gloves to prevent serious injury.

STEP 1 Read and understand all steps in the instructions before starting the installation. Park the motorcycle on a hard, level surface and turn off the ignition. Allow the hot engine and exhaust system to cool.

NOTICE

The following are **GUIDELINES** to assist in the installation of the Adjustable Mustache Bar. It is up to the installer to determine the safest and most comfortable installation.

STEP 2 **PIC 1** depicts the recommended mounting location. Determine the frame down tube diameter. The kit includes 1.25" diameter clamps and bushings that allow the clamps to be mounted on 1.125" diameter down tubes. If necessary, use the included double sided tape to secure the bushings in place during installation. Determine the Mustache Bar mounting location before beginning installation.

NOTICE

Avoid damage to the motorcycle. Protect painted surfaces with a soft cloth or blanket.

The clamps may scratch painted surfaces. Protect painted surfaces with masking tape when determining the mounting position.

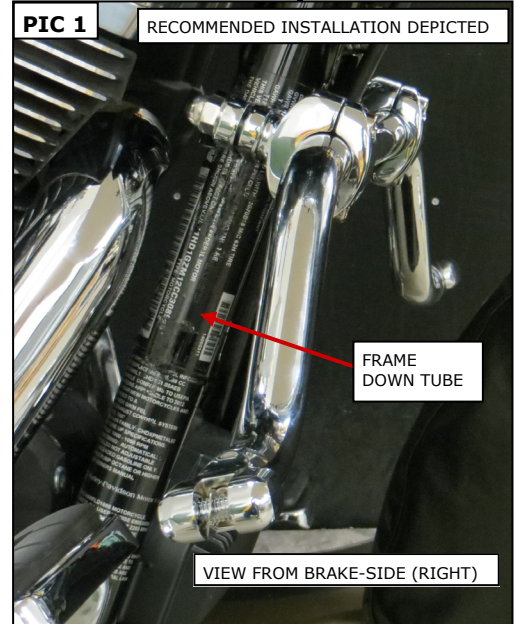

STEP 3 The clutch cable may need to be rerouted and secured in a different location. Remove any wire ties, clips or cable ties on the frame down tubes to allow for cable re-routing. The cable will be secured later.

STEP 4 Refer to **PIC 2**. Assemble a 1.25" Inner and Outer clamp around the frame down tube in the desired location (use bushings if necessary). The clamps are marked 1.25 on the inside surface. Loosely secure the clamp with an included 7/16"-14 X 1" hex head screw and flat washer. Repeat for the other clamp.

NOTE: The parts are shown disassembled and off of the bike for clarity. All parts should be installed on the bike as described in the following **STEPS**.

STEP 5 Refer to **PIC 3 and 4**. Insert an included 7/16"-14 X 1.5" hex head screw through a 1" Inner Clamp and the 1.25" clamp halves.

STEP 6 Refer to **PIC 5**. Place a flat washer over the threaded end of the screw; secure the Inner Clamp with an included acorn nut. Leave snug for now to allow for adjustment.

STEP 7 Repeat **STEPS 5 and 6** for the other side.

STEP 8 Refer to **PIC 6 on PAGE 3**. Insert the included 5/16"-18 X 3/4" socket head cap screws through the 1" Outer Clamps; set the Outer Clamps within arms reach of the work area.

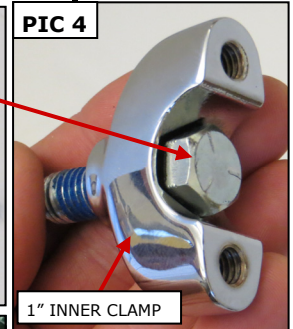
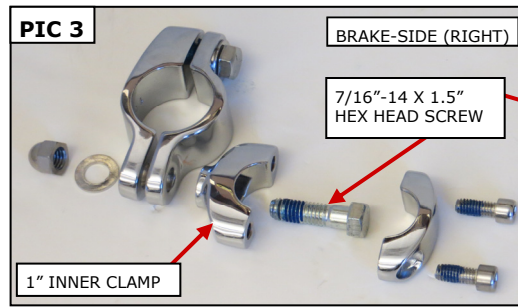
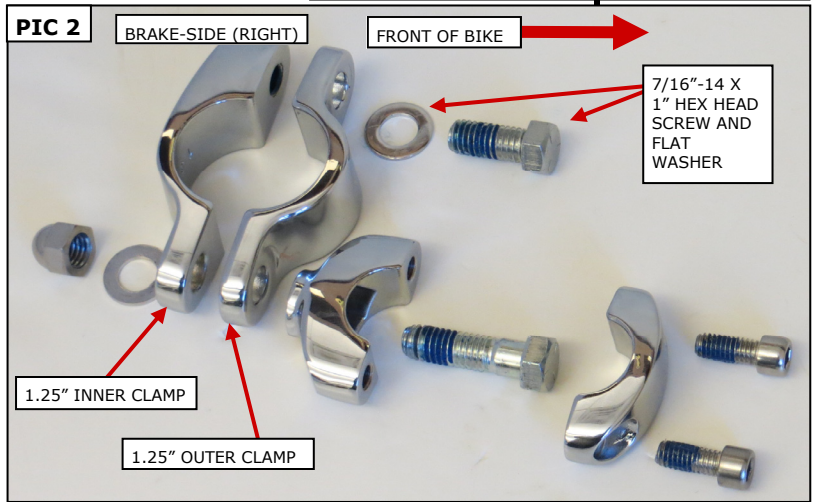

-cont.-

STEP 9 Refer to **PIC 6**. Test fit the Mustache Bar in the 1" Inner Clamps.

NOTE: Determine the best location to secure the clutch cable at this time. Ensure that the cable will function properly and not interfere with the operation of the motorcycle.

STEP 10 Ensure the 1.25" Clamps are aligned evenly. Loosen the hex screw and acorn nut to adjust the Clamps if necessary. Leave the fasteners snug for now to allow for further adjustment.

NOTE: The Adjustable Mustache Bar is depicted assembled off of the bike for clarity. All parts should be installed on the bike as described.

STEP 11 Secure the Mustache Bar to the 1" Clamps with the Outer Clamps from **STEP 8**; leave the fasteners snug to allow for adjustment.

STEP 12 Ensure the Mustache Bar is aligned correctly; tighten the fasteners starting with the 5/16" screws in the Outer clamps. Tighten the acorn nuts, then the hex head screws.

NOTE: Refer to **PIC 7**. Alternately tighten the screws and acorn nuts to ensure that the gaps are even.

STEP 13 Refer to **PIC 8**. Attach the included clevises to the Mustache Bar with the two included 5/16"-18 X 1" socket head cap screws.

NOTE: Clevis orientation: Refer to **PIC 8**. Ensure that the footpeg stop is on the top side and the screw hole faces rearward.

STEP 14 Install the footpegs (sold separately). Follow the specific installation instructions included with the footpegs. Secure the footpeg in the clevis with the included 3/8"-16 X 1" socket head cap screw. Use the included wave washer(s) to take up any extra space between the footpeg adapter and clevis.

STEP 15 Secure the clutch cable to the frame down tube with a cable tie.

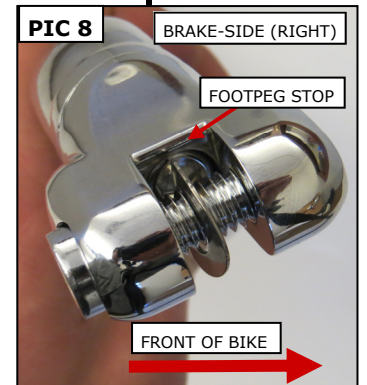
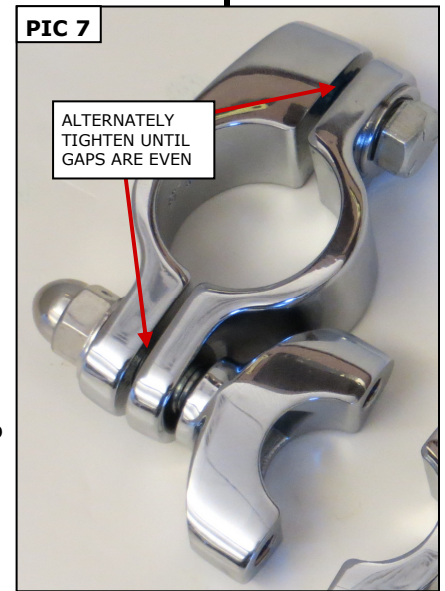
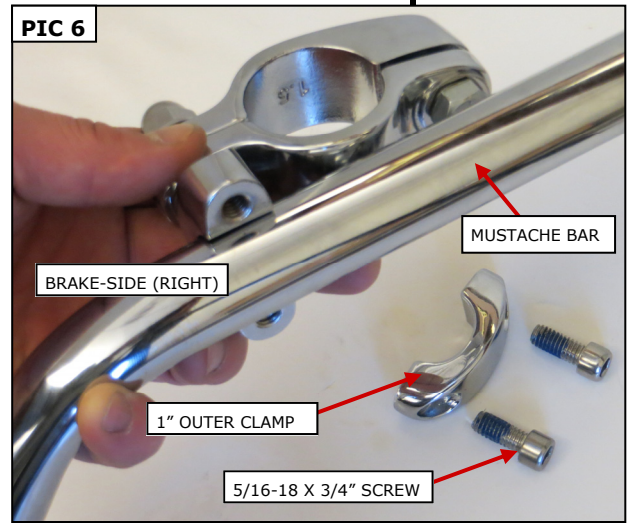

FOOTPEGS MUST BE INSTALLED SO THEY WILL FOLD UPWARD AND REARWARD IF HIT BY ANY OBJECT. FAILURE TO ADJUST THE FOOTPEGS TO OPERATE IN THIS MANNER COULD RESULT IN SERIOUS INJURY OR DEATH.

FULLY COMPRESS THE FRONT FORK AND OPERATE THE FOOT CONTROLS TO ENSURE PROPER CLEARANCE BETWEEN THE MUSTACHE BAR/PEG ASSEMBLY AND THE FENDER, SHIFTER AND BRAKE PEDAL BEFORE RIDING THE MOTORCYCLE. TURN THE HANDLEBARS SIDE TO SIDE TO EACH STOP WITH THE SUSPENSION COMPRESSED AND EXTENDED TO ENSURE THERE IS NO INTERFERENCE. INADEQUATE CLEARANCE BETWEEN THESE COMPONENTS COULD RESULT IN DEATH OR SERIOUS INJURY.

Ride On!