



BLACK CURVED PLATE FRAME and MOUNT 3147

PARTS INCLUDED

- 1 License Plate Frame
- 1 Curved Back Plate
- 1 Hardware Kit Including:
 - 4 1/4-20 x 7/16 Flat Head Cap Screw
 - 2 Adhesive Foam Tape
 - 2 1/2" Bumper Pad
- 1 Installation Instructions

Please read and understand entire instructions before starting installation.

THANK YOU FOR CHOOSING KÜRYAKYN!

IN ORDER TO PROTECT YOU AND OTHERS FROM POSSIBLE INJURY AND/OR PROPERTY DAMAGE OR LOSS, PLEASE PAY CLOSE ATTENTION TO ALL INSTRUCTIONS, WARNINGS, CAUTIONS AND ATTENTION NOTES REGARDING THE USE AND CARE OF THIS PRODUCT.

ATTENTION! This indication alerts you to the fact that ignoring the contents described herein may negatively affect product performance and functionality.

TOOLS SUGGESTED

Set of Hex Wrenches, Socket Set with Ratchet, Combination Wrenches

STRICTLY OBSERVE THE FOLLOWING GUIDELINES IN ORDER TO USE THE PRODUCT PROPERLY AND AVOID POTENTIALLY DANGEROUS ACCIDENTS.

STEP 1 Read and understand all steps in the instructions before starting the installation. Park the motorcycle on a hard, level surface and turn off the ignition.

NOTE Pictures shown are using a chrome version of this part. Assembly will be the same for this new black version.

STEP 2 Locate the two screws on the inside of the rear fender that secure the rear light bar. Remove these screws and set them aside for reinstallation.

ATTENTION! You may want to use masking tape or a soft cloth and apply that to the fender to prevent scratching or damaging the paint.

STEP 3 Pull the light bar away from the bike and turn it over to the backside. Identify the two screws (PIC 1) that secure the stock license plate bracket and remove them. Set them aside, you will reuse this hardware with the new bracket.

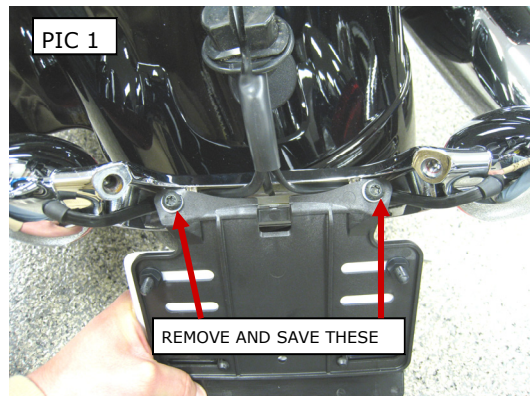

-cont.-

3147-21HD-0111

CUSTOMER SERVICE

877.370.3604 (toll free)

INSTALLATION QUESTIONS

techsupport@kuryakyn.com
or call 715.247.2983

LIMITED WARRANTY

Kuryakyn warrants that any Kuryakyn products sold hereunder, shall be free of defects in materials and workmanship for a period of one (1) year from the date of purchase by the consumer excepting the following provisions:

- Kuryakyn shall have no obligation in the event the customer is unable to provide a receipt showing the date the customer purchased the product(s).
 - The product must be properly installed, maintained and operated under normal conditions.
 - Kuryakyn makes no warranty, expressed or implied, with respect to any gold plated products.
 - Kuryakyn shall not be liable for any consequential and incidental damages, including labor and paint, resulting from failure of a Kuryakyn product, failure to deliver, delay in delivery, delivery in nonconforming condition, or for any breach of contract or duty between Kuryakyn and a customer.
- Kuryakyn products are often intended for use in specific applications. Kuryakyn makes no warranty if a Kuryakyn product is used in applications other than intended.
- Kuryakyn electrical products are warranted for one (1) year from the date of purchase by the consumer. L.E.D.'S contained in components of Kuryakyn products will be warranted for defects in materials and workmanship for 3 years from the date of purchase where as all other components shall be warranted for one(1) year. This includes, but is not limited to; control modules, wiring, chrome & other components.
- Kuryakyn makes no warranty of any kind in regard to other manufacturer's products distributed by Kuryakyn. Kuryakyn will pass on all warranties made by the manufacturer and where possible, will expedite the claim on behalf of the customer, but ultimately, responsibility for disposition of the warranty claim lies with the manufacturer.

ABOUT OUR CATALOG

For purchasing Kuryakyn® products, you can receive a complete catalog free of charge. Send the Proof-of-Purchase below with your address to: Kuryakyn, P.O. Box 339, Somerset, WI 54025. Please indicate either Accessories Catalog for Harley-Davidson® or GL & Metric Cruisers.

Be sure to ask your local dealer about other Kuryakyn® products, the motorcycle parts and accessories designed for riders by riders.

©2005 Kuryakyn USA® All Rights reserved.



STEP 4 Take the new Back Plate (PIC 2) and secure it to the light bar with the screws that were removed in Step 3.



STEP 5 Reinstall the light bar with the two screws that were removed in Step 2. Be sure that the rubber wire grommet (PIC 3) is in place before completely tightening the fasteners

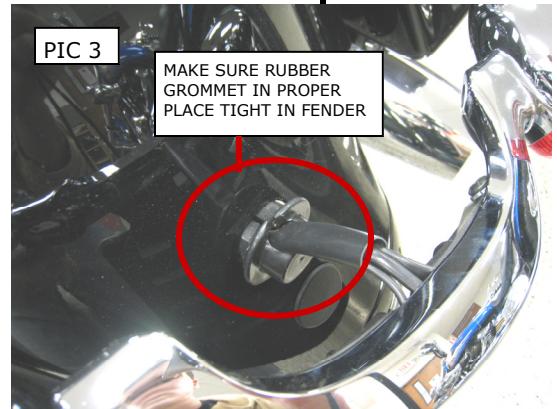

STEP 6 As shown in PIC 4, place the 1/2" Bumper Pads between the new Back Plate and the rear fender. Clean with an ammonia based cleaner like Windex and dry the rear fender where the Bumper Pad will be installed. Peel the adhesive tape backing from the Bumper Pads, stack one on top of the other and stick to the fender over the plastic plug.



NOTE The bumper pads are provided to avoid excess vibration to the plate mount. The bumper pads may fit tightly when stacked and put in place behind the plate mount.

ATTENTION!

Ensure the area of installation is free of grease, oil, dirt or other debris to ensure proper adhesion. Küryakyn WILL NOT issue a warranty on any parts lost due to improper installation.

ATTENTION!

The adhesive will not bond correctly if applied at temperatures less than 50°F. Do not attempt this installation in temperatures less than 50°F.

STEP 7 Once you have the Back Plate secured you can install the license plate and secure the License Plate Frame (PIC 5) with the four 1/4-20 x 7/16 Flat Head Cap Screw. Tighten all fasteners.



NOTE Due to the varying sizes of license plates, modification of the plate may be necessary to make it fit. If the plate fits loosely in the frame, the Adhesive Foam Strips can be installed between the Back Plate and the license plate to help stop vibration and avoid damage to the new frame or license plate.

ATTENTION!

It is the installer's responsibility to ensure that all of the fasteners (including preassembled) are tightened before operation of the motorcycle. Küryakyn will not issue a warranty on components lost due to improper installation. Periodic maintenance may be required.

Ride On!

-cont.-

PRODUCT NAME HERE

INSTALLATION

Ride On!