



INSTALLATION INSTRUCTIONS

PART NUMBER: RK-3942

This Assembly Fits:

SEE CATALOG FOR CURRENT APPLICATIONS

Congratulations, you have purchased the finest custom air cleaner that money can buy. With proper care, this filter will last 1 million miles or more. This custom air cleaner replaces the stock air cleaner assembly. The following procedure **MUST** be followed to ensure a proper fit and seal of the custom air cleaner.

TOOLS NEEDED:

ratchet
extension
7/16" socket
T27 TORX
3/4" wrench
5/16" allen wrench
3/16" allen wrench
5/32" wrench

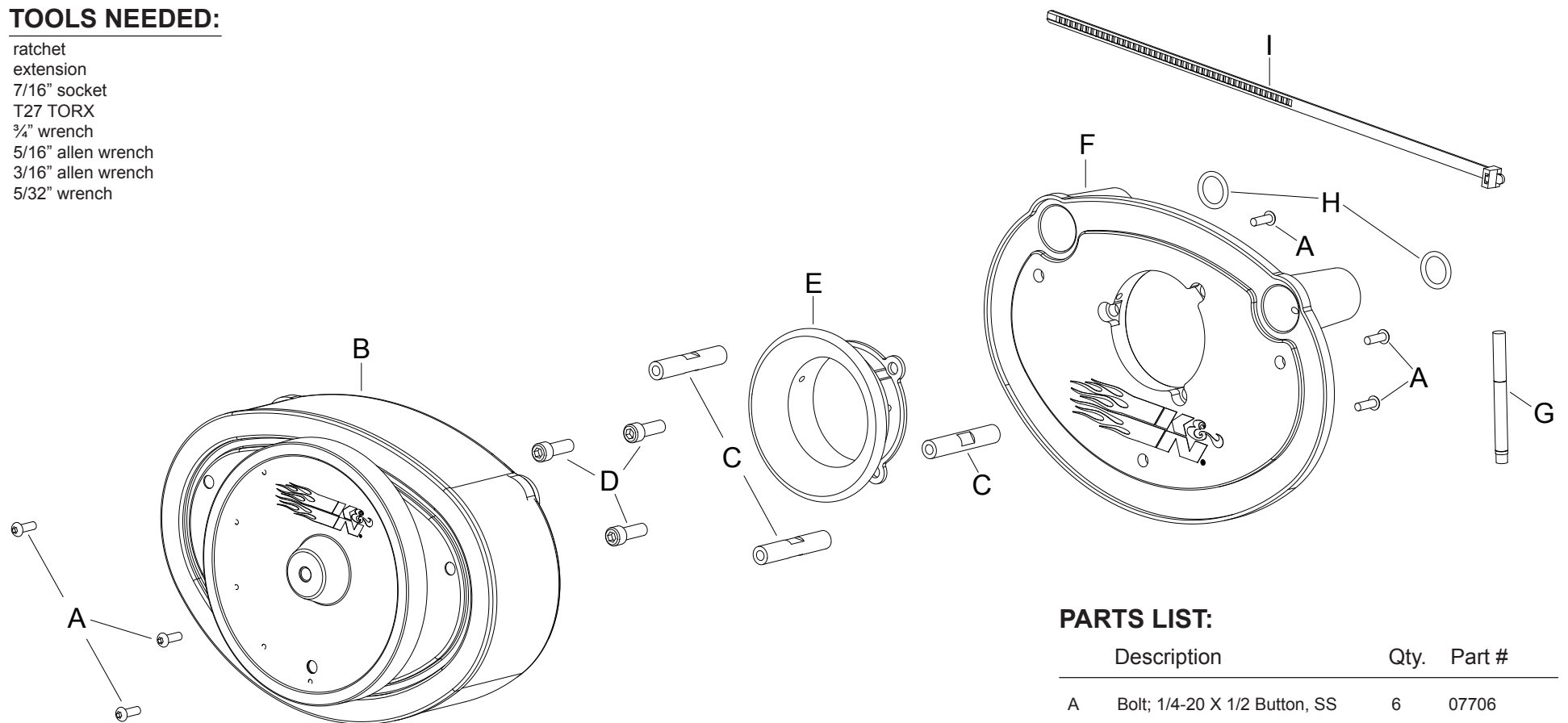

PARTS LIST:

	Description	Qty.	Part #
A	Bolt; 1/4-20 X 1/2 Button, SS	6	07706
B	Air Filter	1	E-3980
C	Spacer, 0.375" OD X 0.25" ID	3	06500-1
D	Screw; 1/4-20 X 3/4 SOC. HD SS	3	07731
E	Velocity Stack, RK-3942	1	08939
F	Back Plate	1	01915
G	2ML, Medium Stregnth, Blue	1	482
H	O-Ring, 9/16" ID, .10 Thick	2	07761
I	Cable Ties; 11" Black	1	21590

NOTE: FAILURE TO FOLLOW INSTALLATION INSTRUCTIONS AND NOT USING THE PROVIDED HARDWARE MAY DAMAGE THE THROTTLE BODY AND ENGINE.

TO START:

1. Turn off the ignition and disconnect the negative battery cable.



2. Remove air filter cover mounting bolt and cover from the vehicle as shown.

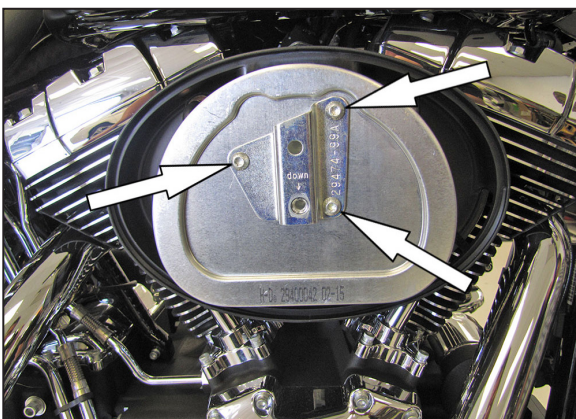

3. Remove the three bolts which secure the stock air filter element. Then remove the stock air filter element and stock crank case breather hoses as shown.

NOTE: The stock breather hoses will not be reused with the K&N® custom assembly.

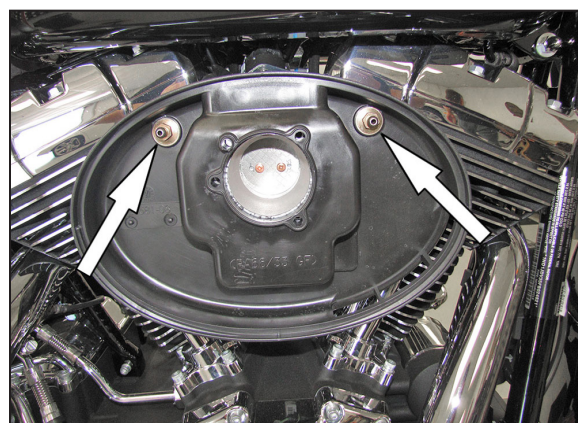

4. Remove the stock breather bolts which secure the stock air filter base shown.



5. Remove the stock air filter base and gasket from the engine as shown.

NOTE: K&N Engineering, Inc. recommends that customers do not discard the factory air intake components.

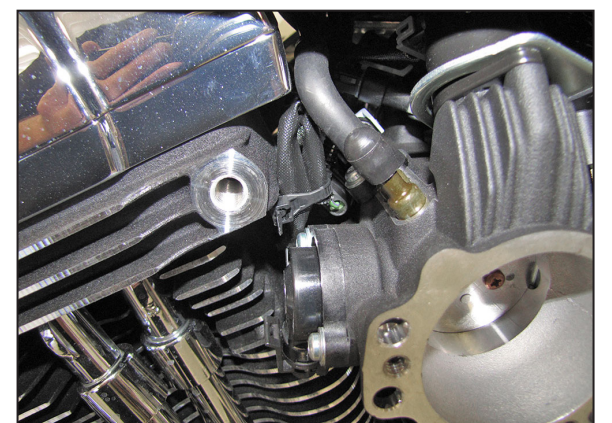

6. On models equipped with an intake valve solenoid connector on the back of the stock air filter back plate; unhook the connector from back plate and use the provided tie wrap to secure it behind the throttle body.

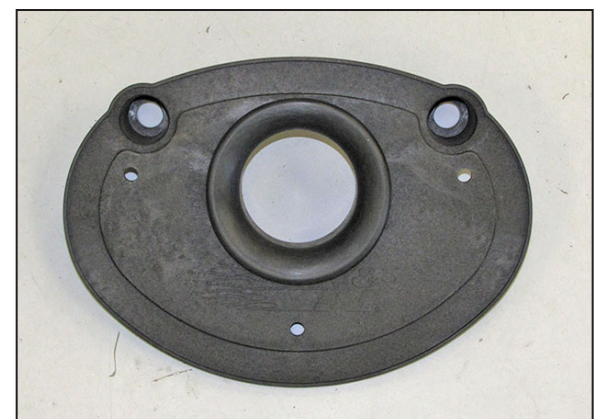

7. Install the provided velocity stack into the K&N® backing plate as shown and install the three throttle body mounting bolts.

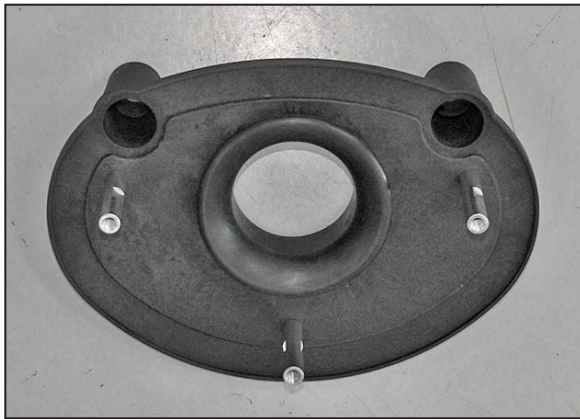

8. Install the three stand-offs onto the backing plate using the three bolts provided.

NOTE: Be sure to use the provided thread locker on the stand-off bolts.

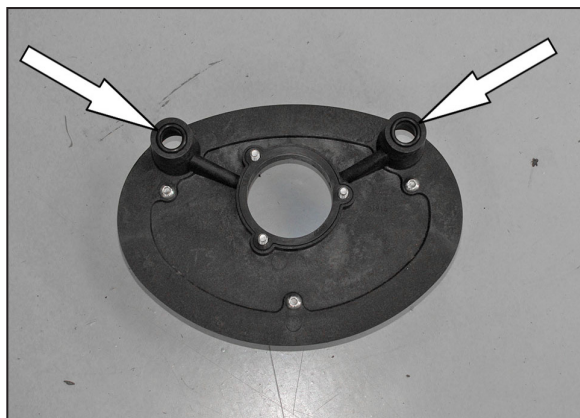

9. Install the two provided O-Rings onto the crank case breather ports.



10. Install the back plate and secure with the stock breather bolts. Tighten the three bolts that secure the back plate to the throttle body. Then tighten the two breather bolts fully.

NOTE: Before installing the back plate onto the vehicle, be sure to apply the provided threadlocker to the throttle body bolts.

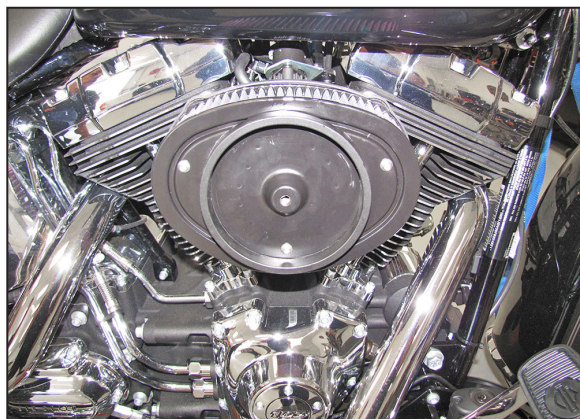

11. Install the K&N® air filter and secure with the three bolts provided.

NOTE: Be sure the filter is properly sealed before completely tightening the mounting bolts.



12. Reinstall the factory chrome cover and secure with the factory bolt.

NOTE: Be sure to not over tighten the mounting bolt and distort the cover.



13. Reconnect the vehicle's negative battery cable. Double check to make sure everything is tight and properly positioned before starting the vehicle.

14. It will be necessary for all K&N® custom air cleaners to be checked periodically for realignment, clearance and tightening of all connections. Failure to follow the above instructions or proper maintenance may void warranty.

ROAD TESTING:

1. Start the engine with the transmission in neutral. Listen for air leaks or odd noises. For air leaks secure hoses and connections. For odd noises, find cause and repair before proceeding. This kit will function identically to the factory system except for being louder and much more responsive.

2. Test ride the vehicle. Listen for odd noises or rattles and fix as necessary.

3. If road test is fine, you can now enjoy the added power and performance from your kit.

4. K&N Engineering, Inc., requires cleaning the intake system's air filter element every 50,000 miles. When used in dusty or off-road environments, our filters will require cleaning more often. We recommend that you visually inspect your filter once every 25,000 miles to determine if the screen is still visible. When the screen is no longer visible some place on the filter element, it is time to clean it. To clean and re-oil, purchase our filter Recharger® service kit, part number 99-5050 or 99-5000 and follow the easy instructions.